

HARDWORKING HERO: JOB 610

Road Runner. Why use a fuel-guzzler just to pick up a part from a supply house, shuttle a worker from site to site, or run errands when a street-legal Carryall 510 LSV are so much less expensive? This zero-emission electric vehicle cost just pennies a day to operate, makes parking a breeze and gets about 30 miles to a full charge.



HARDWORKING HERO: JOB 555

Green power. Busy downtown areas can be a challenge. Congestion, pollution and limited parking can create issues for parking enforcement. The Carryall 710 street-legal LSV overcomes these issues and for just pennies a day.



1,000 JOBS. ONLY ONE
CARRYALL

1.800.ClubCar

www.clubcar.com

ClubCar

®

CARRYALL 510/710



VERSATILITY & RELIABILITY

Payload. Total Vehicle Capacity of up to 1150 lb (510 Kg).

Street legal. Carryall LSVs can be driven on streets with speed limits of 35 mph or less in almost all states. Check state and local laws.

Green. Reduce your carbon footprint and cut fuel costs with this sturdy electric vehicle.

Safety-equipped. Carryall LSVs come with all required safety equipment: headlights, tail lights, turn signals, horn, 3-point safety belts, hip restraints and more.

Improved charging. The industry's only standard on-board high-efficiency charger with cord retractor. This new system operates on voltages around the globe, and tolerates voltage swings that would shut down lesser chargers.

More durable than steel. Carryalls are built on Club Car's exclusive lightweight, rustproof, air-craft-grade aluminum frame that's designed to be stronger than steel. Unlike competitive steel frames, it resists corrosion and retains resale value.

Fit-to-task utility. A one-of-a-kind bed box with an integrated track-based attachment system, optional tool holders, bed dividers and cargo tie downs increases versatility and saves floor space. So you can do more with less.

The best warranty in the industry. The industries longest standard battery, powertrain and bumper to bumper warranty.

CATEGORY	510 ELECTRIC	710 ELECTRIC
Engine/Motor Type	48-volt 3-phase AC	
Controller	400 Amp - Solid State	
Horsepower (Rated)	4.4 hp (3.3 kW), Peak 16 hp (11.7 kW)	
Drive Unit	12.3:1 direct-drive axle, double reduction helical gear	
Gear Selection	Forward/Neutral/Reverse	
Batteries	(8) 6-volt Flooded Lead Acid	
Charger	On-board DeltaQ QuiQ (1KW High Frequency)	
Lighting	37.5 Watt Halogen headlights, turn signals, horn, and LED taillights/brake light	
Steering Mechanism	Self-adjusting Rack and Pinion	
Suspension (Front)	Independent leaf spring with dual hydraulic shocks	
Suspension (Rear)	Leaf springs with dual hydraulic shocks	
Brakes	4-wheel hydraulic; front disc, rear drum	
Park Brake	Hand-operated	
Body (Front & Finish)	ArmorFlex® with automotive paint/clear coat	
Body (Rear)	Rust-proof aluminum	
Tires	205-65-10 6-PLY, DOT	
Wheelbase	74.3 in (188.72 cm)	
Overall Height	78.1 in (198.3 cm)	99.1 in (251.7 cm)
Overall Length	118 in (299.7 cm)	137.5 in (349.3 cm)
Bed L x W x H (Cargo Box)	44.2 x 47.5 x 10.5 in (112.2 x 120.6 x 26.6 cm)	67.6 x 49.8 x 10.5 in (171.7 x 126.5 x 26.7 cm)
Ground Clearance (Differential)	5.6 in (14.2 cm)	
Track Width (Front)	34.6 in (87.8 cm)	
Track Width (Rear)	39.2 in (99.5 cm)	
Overall Width (with Mirrors)	62.6 in (159.0 cm)	
Total Vehicle Capacity	950 lb (430.0 kg)	1050 lb (476 Kg)
Bed Load Capacity	550 lb (249.5 kg)	850 lb (385.6 kg)
Towing Capacity	1150 lb (510 Kg)	1050 lb (476 Kg)
Combined Gross Vehicle Capacity	1150 lb (510 Kg)	1050 lb (476 Kg)
Curb Weight (w/ Batteries)	1656 lb (751 Kg)	1765 lb (801 Kg)
Max Speed	25 mph (40 kph)	
Warranty	2-year, limited vehicle / 4-year battery	

ACCESSORIES & OPTIONS

1. Vehicle Colors

2. Wheel Cover

3. Brush Guard

4. Flatbed

5. Stakeside

6. Cargo Box

7. Rear Receiver Hitch

8. Cab (Shown with optional glass doors)

9. Automotive Instrument Panel (Standard Feature)

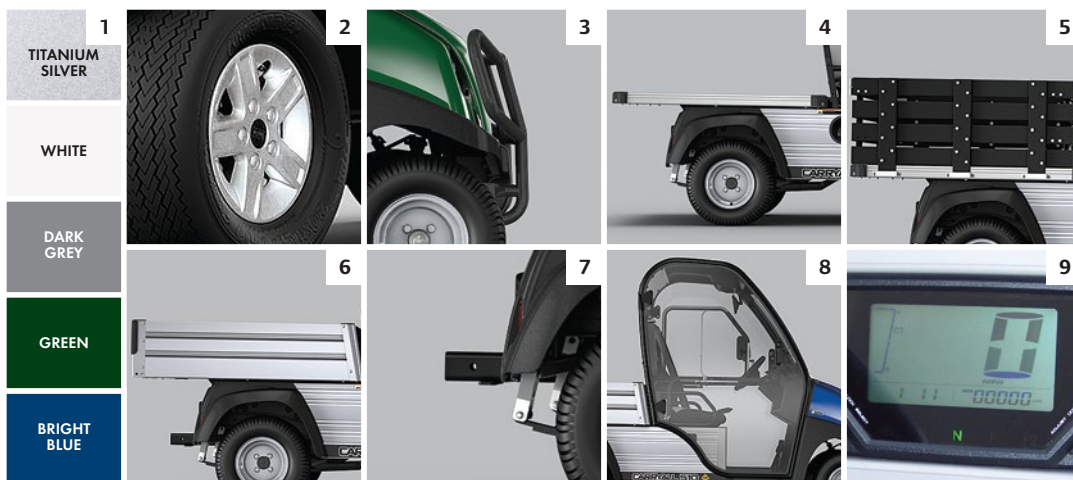

877.683.1032

sales | rentals | parts | service

nessturf.com